

Kent Triple Seal Water Tight Manhole—KMHT(W)

The Kent Triple Seal Water Tight Manhole KMHT(W)600/600 is both odour and water tight. All three seals make a positive connection and the manhole has locking points surrounding the bottom sealing plate to guarantee this seal. A full width stainless plate is sealed to the frame by multiple lockdown points over a neoprene seal. Then there are 2 further sealing strips each containing 2 contact points between the top tray and the frame below down to the frame. The 4 lockdown points in the corners help this compression. In effect these covers have > 3 seal points each.

Often these manholes are used when there is a concern about back pressure from below. The standard design withstands 0.2—0.6 bar back pressure. Higher pressure versions can be supplied on request.

They come in a variety of sizes and can be fabricated to any bespoke dimension up to 900mm Square. They are designed to be filled with material to match the surrounding floor finish - Concrete, Resin or Tiles.

The 80mm deep tray versions are Medium Duty to Heavy Duty loading depending on their overall size and are suitable for Industrial use with light or heavy vehicular traffic. Typically these are used internally in Meat, Dairy, Beverage or Pharmaceutical Factories with white wellie traffic plus regular forklifts up to 11 ton depending on which variation is specified.

- Guaranteed water tight
- Back pressure plate
- Fabricated to any dimension
- Grade 304 or 316 stainless steel
- 4 lifting points as standard
- Lockdown as standard
- Can suit FACTA D loading

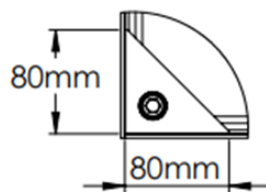
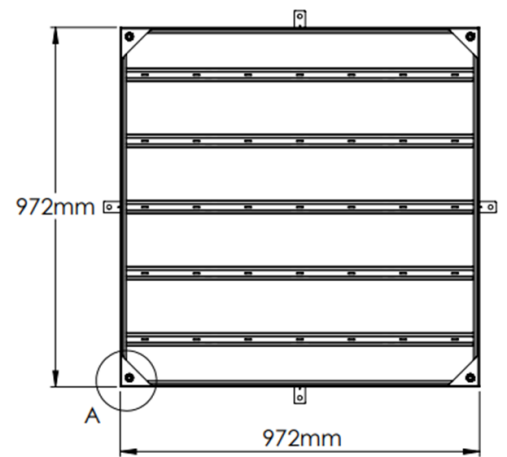
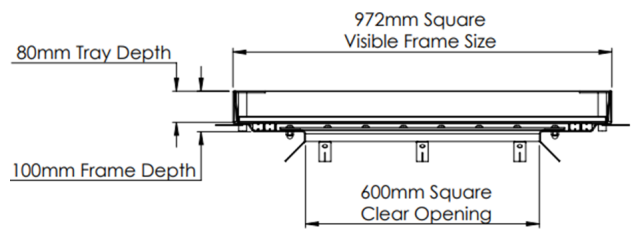

DETAIL A

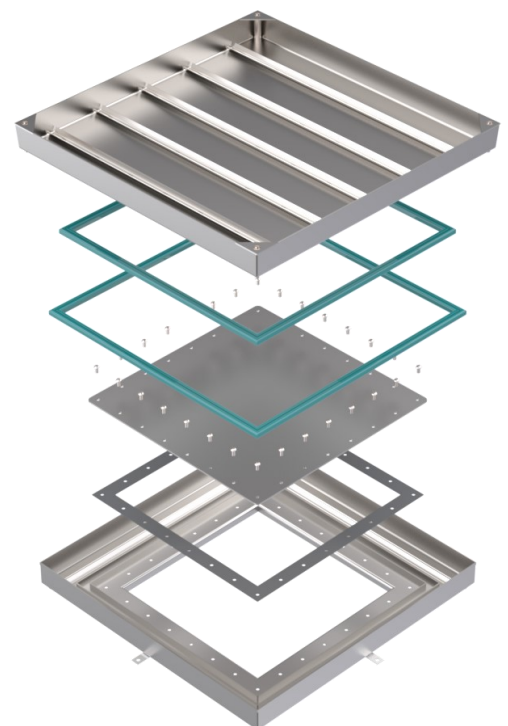

Kent Triple Seal Water Tight Manhole—KMHT(W)

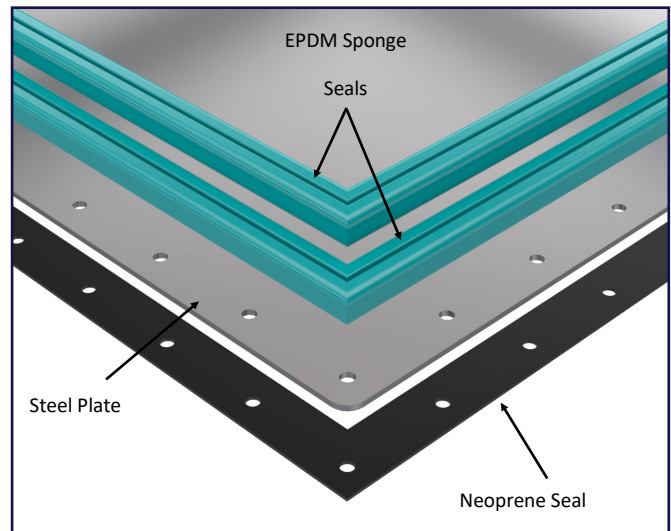
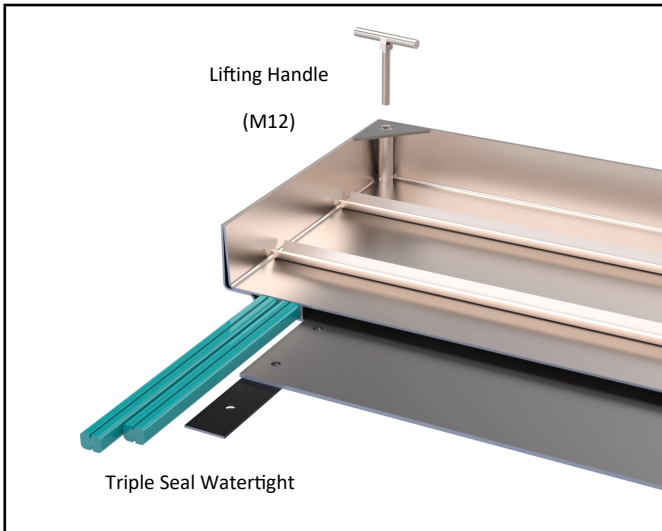

Tray must be filled with fibre reinforced concrete grade C35/45 to with 12mm of the top surface.

Product Code	Clear Opening	Visible Frame Size	FACTA Class
KMHT(W)300/300/80	300mm x 300mm	672mm x 672mm	D
KMHT(W)450/450/80	450mm x 450mm	822mm x 822mm	D
KMHT(W)600/600/80	600mm x 600mm	972mm x 972mm	C
KMHT(W)750/750/80	750mm x 750mm	1122mm x 1122mm	B
KMHT(W)900/900/80	900mm x 900mm	1272mm x 1272mm	AAA

EN1253 Class	Load Capacity
M125	12.5T
N250	25T
P400	40T

FACTA Class	Load Capacity
AAA	2.5T
B	5T
C	6.5T
D	11T

Specify: Kent Triple Seal Water Tight Manhole KMHTW 600/600/80; 600mm x 600mm clear opening; 80mm Tray depth; Double Seal; Grade 304 Stainless Steel; Loading FACTA C

(Amend underlined words to suit project)

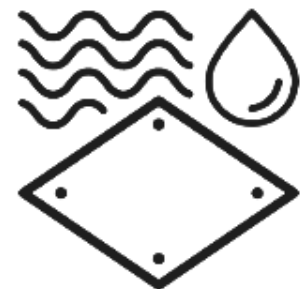

WATER TIGHT