

# Kent Arc Cycle Stand



**Kent**  
STAINLESS





## KENT ARC CYCLE STAND (KACS1250)

### Specify:

Kent Arc Cycle Stand (KACS1250); Grade 316 stainless steel; 4mm thick; Height: 850mm, Length: 1250mm, Diameter:48mm. Satin finish 320 grit polish.

### Description:

The Kent Arc Cycle Stand is made from grade 316 stainless steel. The cycle stand measures 1250mm x 850mm high, it can be made to any specification needed.

The Arc Cycle Stand is a design led alternative to more common stainless steel cycle stands. The robust design allows 2 bicycles to be locked in position per stand.

Widely used in pedestrianised, commercial and parkland areas.

### Features:

- Grade 316 Stainless Steel
- Satin Finish 320 grit polish
- 48mm diameter
- 150mm diameter baseplate
- 4mm thick steel





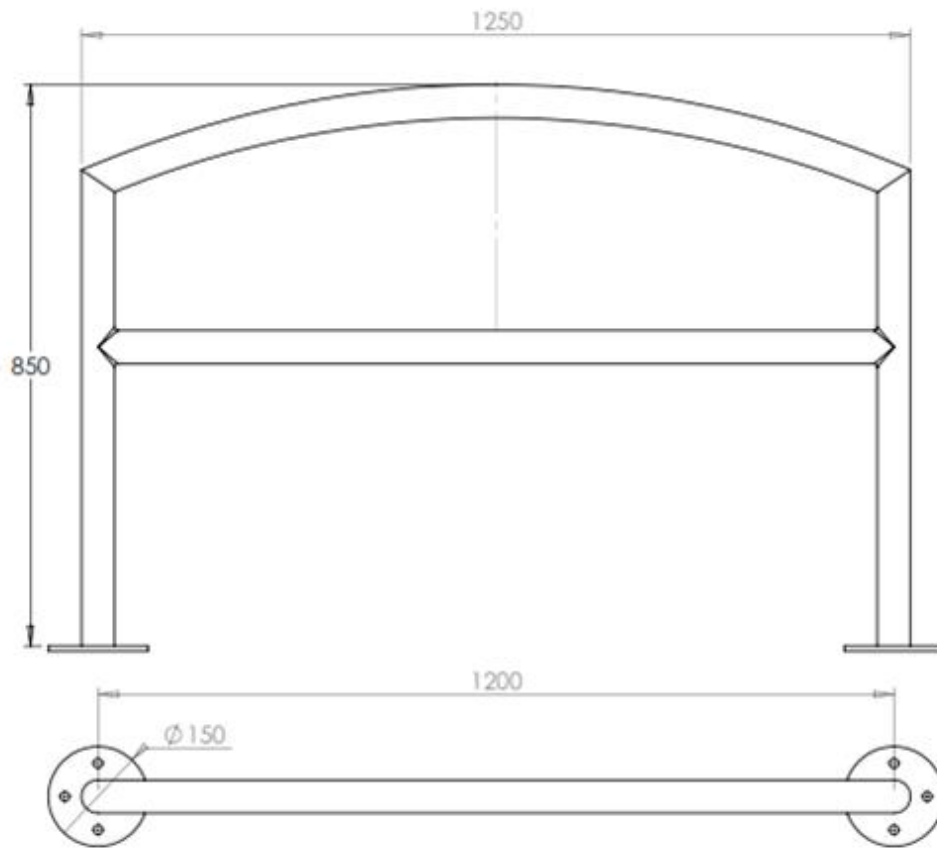

Product Code	Height	Width	Diameter	Thickness of Steel
Kent Arc Cycle Stand (KACS1250);	850mm	1250mm	48mm	4mm





## KENT ARC CYCLE STAND (KACS1250)

### Product Installation

#### Visible Flange:

- Ensure that the surface to which the stand is mounted is sufficiently strong.
- Position the pole in the correct location. Mark the holes and drill into the surface.
- Place the pole directly over the holes and then fix the pole to the surface using M12 bolts.

#### Buried Flange:

- Cast a foundation with a minimum dimension of L350 x W350 x D350mm below the surface.
- Once concrete is set follow steps 1-3 as per flange detail above.
- Fill hole with grout and replace slabs to finish of the pole

#### Cast In:

- Remove pavement and excavate a hole to minimum dimensions of L350 x W350 x D350mm.
- Position your pole in the correct position ensuring correct height and then prop the stand securely.
- Fill the hole with concrete up to the level of the underside of the pavement ensuring a good smooth surface finish..
- Remove props, replace the paving slabs, and ensure that they are well bedded in



## Maintenance of Stainless Steel

Clean the stainless steel components using warm water with a mild detergent with a non-abrasive cloth or sponge. Heavier stains may require the use of a nylon-scouring pad or a stainless steel cleaner.

To remove paint or graffiti use a cloth and Alkaline or solvent paint strippers according to type of paint. In the case of a bead blasted finish, where abrasive cleaning is required, always use a random circular rubbing action with a cloth.

In the case of brushed finishes the surface consists of uniform fine 'scratches' running in one direction so where abrasive cleaning is required always use a straight back and forward rubbing action in the direction of the grain using soap and warm water.

Rust spots or 'tea stains' can occur on the surface of the material, these are normally caused by contamination from ordinary mild steel, particularly in areas where construction work has been undertaken. Such stains can be removed using Rust Remover 410.

In cases where the surface is severely stained because of severe environmental conditions or scratched due to misuse, it may still be possible to restore the original finish using chemicals such as Oxalic Acid solution. There are many stainless steel polishes available to enhance the surface finish.

We recommend Mister Stainless Ltd. as a provider for stainless steel cleaning products.







**KENT ARC CYCLE STAND (KACS1250)**

**Specify**

**Choose your steel:**  
Grade 304 Stainless steel  
Grade 316 Stainless steel  
Mild Steel Galvanised

**Customise your size**  
To suit your projects needs  
or go with our standard  
1250mm Length x 850mm  
height and 48mm  
diameter with 4mm thick

**Specify:**

Kent Arc Cycle Stand (KACS1250); Grade 316 stainless steel; 4mm thick; Height: 850mm, Length: 1250mm, Diameter:48mm. Satin finish 320 grit polish.

**Customise your finish**  
Satin Finish 320 Grit Polish  
Powder-coating  
Shot Peened

**Options**

- Powder-coated
- Satin finish 320 Grit Polish
- Galvanised
- Grade 304 Stainless Steel
- Grade 316 Stainless Steel



**Testimonials**



*“We have no hesitation in recommending Kent Stainless and look forward to working with them on public building projects in the future”*

**- ARUP**



*“ Kent Stainless scored highly in all regards again”*

**- BAM**



*“ Your timely delivery and seamless integration with main contractor Skanska made the overall project a huge success ”*

**- Forward Swindon**





**Kent Stainless Ltd**

Ardcavan, Wexford, Ireland

**TEL NO:** +353 53 9143216  
**UK FREEPHONE:** 0800 376 8377  
**FAX:** +353 53 9141802  
**WEB:** [www.kentstainless.com](http://www.kentstainless.com)  
**EMAIL:** [info@kentstainless.com](mailto:info@kentstainless.com)



**Kent**  
STAINLESS