

KENT HINGED MULTI CHEQUER KHMCHQ-1200/1200

The Kent Hinged Multi Chequer manholes, KHMCHQ-1200/1200 are ideal for covering staircases down to tunnels, or for areas where equipment or supplies (spare parts, generators, substations) may need to be lifted in and out relatively frequently. It is perfect where opening the manhole can be frequent, where a single operator may arrive on site and where maintenance personnel may not have access to specialised lifting equipment.

This makes them ideal for covering tunnels or large underground chambers. They can be supplied with Gas Struts for smaller sizes or with Kent Lift Assist Mechanical Struts for larger sizes.

They are manufactured in accordance with BS9124:2008 and FACTA standards and they are made from Grade 304L or Grade 316L Stainless Steel as standard. Material can be changed to Galvanised Mild steel when required and there is also a Double Sealed version available.

Features

- Gas Struts or Kent Lift Assist Mechanical Struts
- Beam support built into covers
- Optional Safety grid
- Safety stay as standard
- Opens to 90°

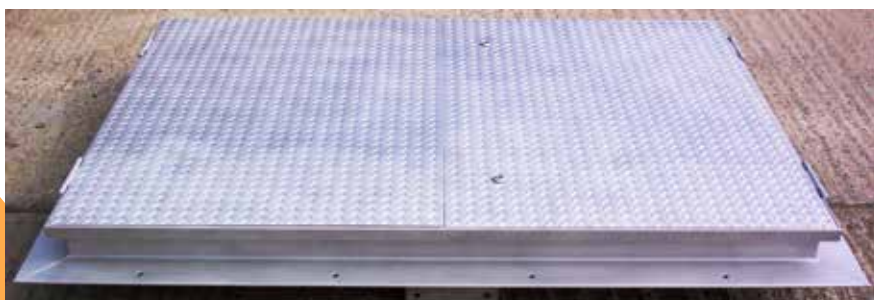
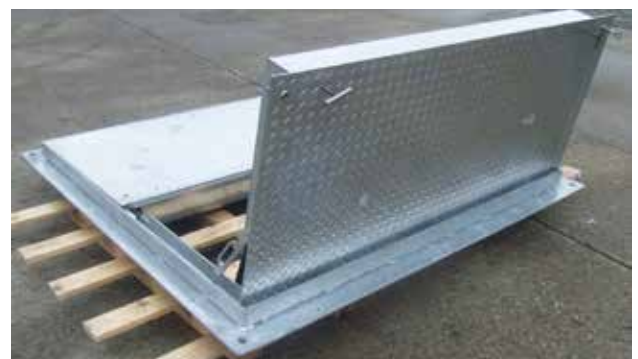

KENT HINGED MULTI CHEQUER KHMCHQ-1200/1200 continued

Product Code	Clear Opening	No. of Trays	Tray Depth	Visible Frame Size (Unsealed)
KHMCHQ-1200/1200	1200mm x 1200mm	2	100mm	1350mm x 1350mm
KHMCHQ-1800/1200	1800mm x 1200mm	2	100mm	1950mm x 1350mm
KHMCHQ-1800/1800	1800mm x 1800mm	2	100mm	1950mm x 1950mm
KHMCHQ-2400/1200	2400mm x 1200mm	2	100mm	2550mm x 1320mm
KHMCHQ-2400/1800	2400mm x 1800mm	2	100mm	2550mm x 1920mm
KHMCHQ-2400/2400	2400mm x 2400mm	2	100mm	2550mm x 2550mm

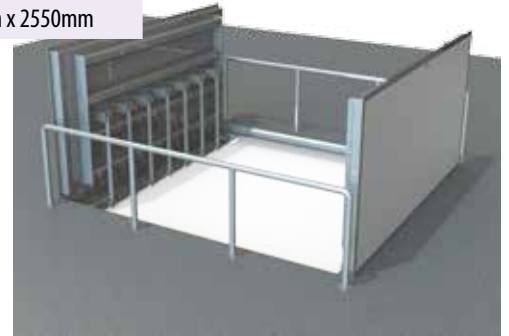
Optional Safety Barrier

Kent Hinged Multi Chequer Manhole KHMCHQ-1200/1200; 1200mm x 1200mm clear opening; 2 Trays; 100mm Tray Depth; Grade 316L Stainless Steel; Loading FACTA B316L Stainless Steel; Loading FACTA B
 See page 8 & 9 which shows how to create your own unique specification clause

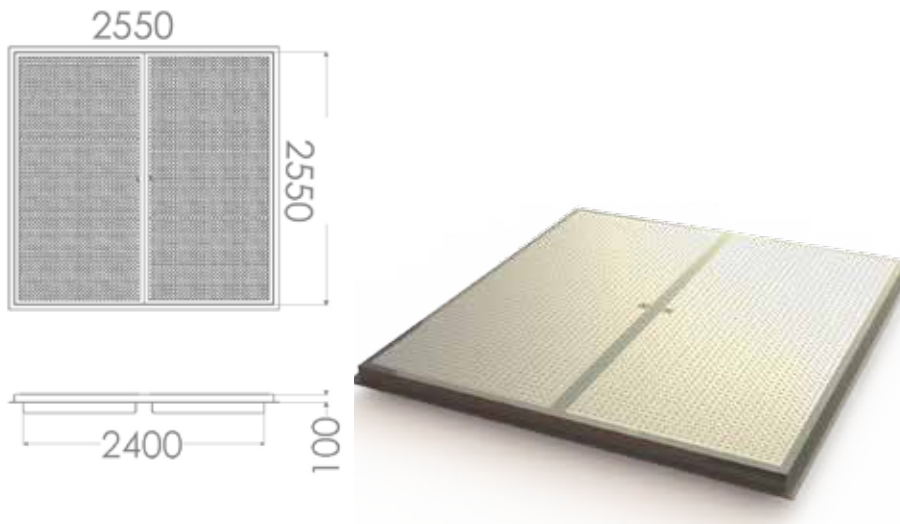
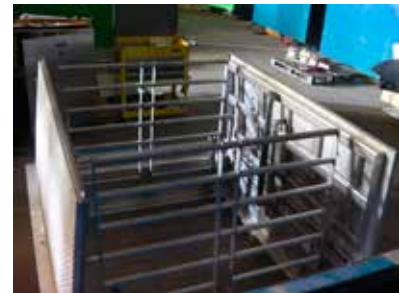
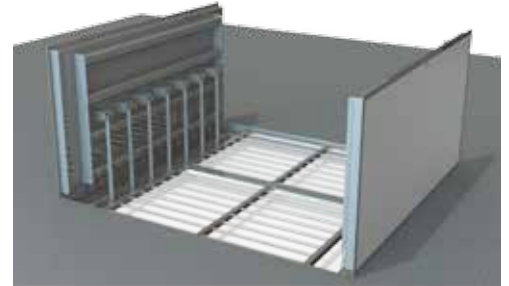
Safety Grid Open

Safety Grid Closed

OPTIONS

- Various Loadings (See BS9124:2008 Application Load Specific and FACTA tables)
- Grade 304L Stainless Steel
- Grade 316L Stainless Steel
- Mild Steel Galvanised (In accordance with BS EN ISO 1461 (1999))
- Mild Steel Galvanised to 140 Micron (minimum requirement for Middle East projects)
- Unsealed or Double Sealed
- Various Tray Depths
- Safety grid
- Kent lift assist Mechanical struts

Application Load Specific (In accordance with BS9124:2008)

1.0T
5.0T
10.0T

FACTA Class	Slow Moving Wheel Loads	Kent Safety Test (Unfilled)
A	0.6T	0.8T
AA	1.5T	3.1T
AAA	2.5T	5.2T
B	5T	10.1T
C	6.5T	13.2T
D	11T	22T