

The KH220/110 Gully is a Round Body, Round Side Outlet Gully for heavy duty areas with high flow rates. They are designed for use primarily in Food/Beverage/Pharmaceutical factories. They can be used in both light-duty and very heavy duty trafficked areas (depending on the grating chosen).

The KH220/110 standard gully takes 10mm thick gratings. The KH220/110DS version of this gully (DS = Deep Swage) takes all 25mm deep gratings offered by Kent (Mesh, Heel-proof slotted, Factory Ladder, Heel-proof perforated, Gratings). When used with Heel-proof gratings it is suitable also for civil projects.

In most cases, a 110mm or 160mm outlet is required, but this can easily be substituted for a 4" or 6" SCH10 outlet pipe. It is trapped as standard with the Kent Weir Trap.

- Features:**
- Grade 304 (1.4301) or 316 (1.4401) Stainless Steel to BS EN 10088
 - Strong
 - Short lead time
 - Usable in both heavy and light duty areas
 - Suitable for internal factory drainage and external civil drainage projects

GRATING OPTIONS

FACTORIES



STREETSCAPES



40mm wider Reinforced Edge Frame for Heavy Traffic



Holding Flange Puddle Flange DPM Clamp Flange

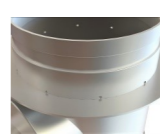

Puddle Flange Weepholes



110mm Side Outlet Pipe as Standard 4" SCH10 Pipe Optional Flanged Optional



Filter / Debris Basket

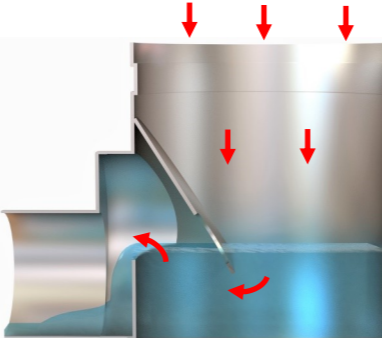

Waterflow

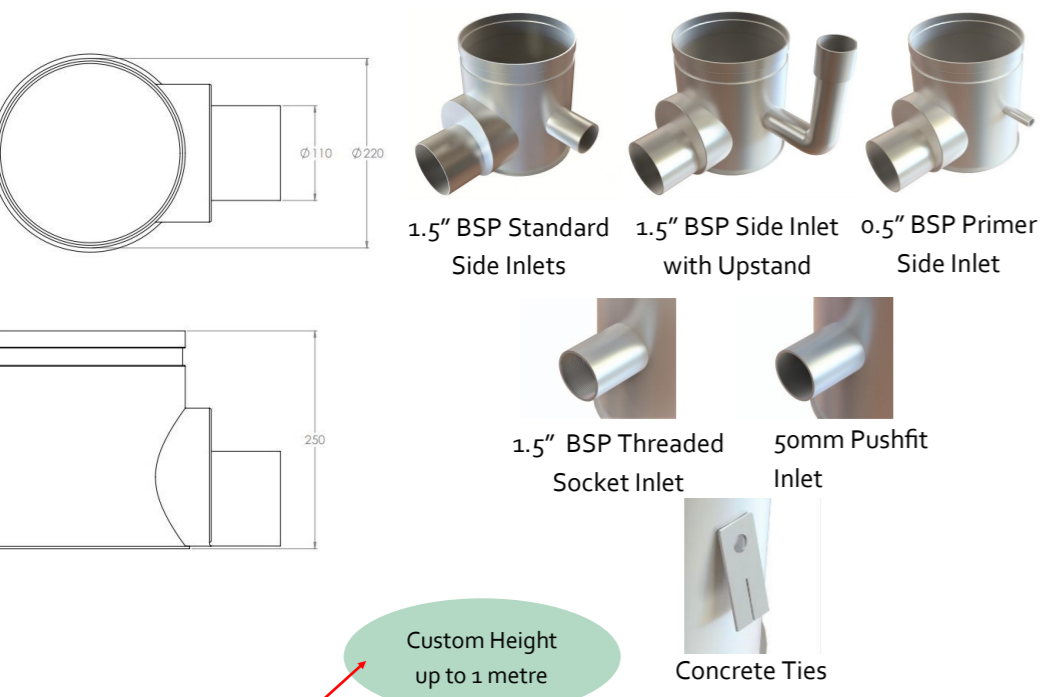

Product Code	Height	Width	Length	Outlet	Swage	Flow Rate*
KH220/110	250	220/260	220/260	110	10	5.10l/s
KH220/110DS	250	220/260	220/260	110	25	5.40l/s
KH270/110	250	270/310	270/310	110	10	5.10l/s
KH270/110DS	250	270/310	270/310	110	25	5.40l/s
KH370/160	300	370/410	370/410	160	10	10.40l/s
KH370/160DS	300	370/410	370/410	160	25	10.60l/s

*flow rate is also dependent on grating chosen.

Specify: Kent KH220/110 trapped industrial gully; 220mm diameter; grade 304 stainless steel; complete with _____ grating.
 Choose the product code from the dimensions table above.
 Add specification options from the next page.

BS EN1253 Loading Class L15 / R50 / M125 / N250 / P400
 Our internal gullies can be subjected to very heavy loads but must have the correct heavy duty grating to achieve these loads. Suitable for Factories and Leisure Centres.
 (BS EN1253 Gullies & Buildings)

BS EN124 Loading Class A15 / B125 / C250 / D400
 Our external gullies can be subjected to very heavy loads but must have the correct heavy duty grating to achieve these loads. Suitable for Streetscapes.
 (BS EN124 Gullies for Vehicular & pedestrian areas)