

Kent Brass Tactile Warning Stud



KENT BRASS TACTILE WARNING STUD (KBTWS 35/5/FDMG)**Specify:**

Kent Brass Tactile Warning Stud (Multi Groove) KBTWS 35/5/FDMG; 35mm diameter x 5mm high; multi rings; Brass 59, 6mm dia x 14mm stud for root fixing below GL

Description:

The Brass Kent Tactile Warning Studs provide an underfoot warning to identify hazards and dangerous areas where there is a change in levels or where there is an unprotected opening such as open stairwells and platforms.

The slip resistant design ensures the studs do not themselves become a hazard in wet or cold conditions.

Features:

- Brass 59 material
- 5mm high
- 35mm dia Disc
- Multi Groove
- 1 Installation pins
- Easy installation

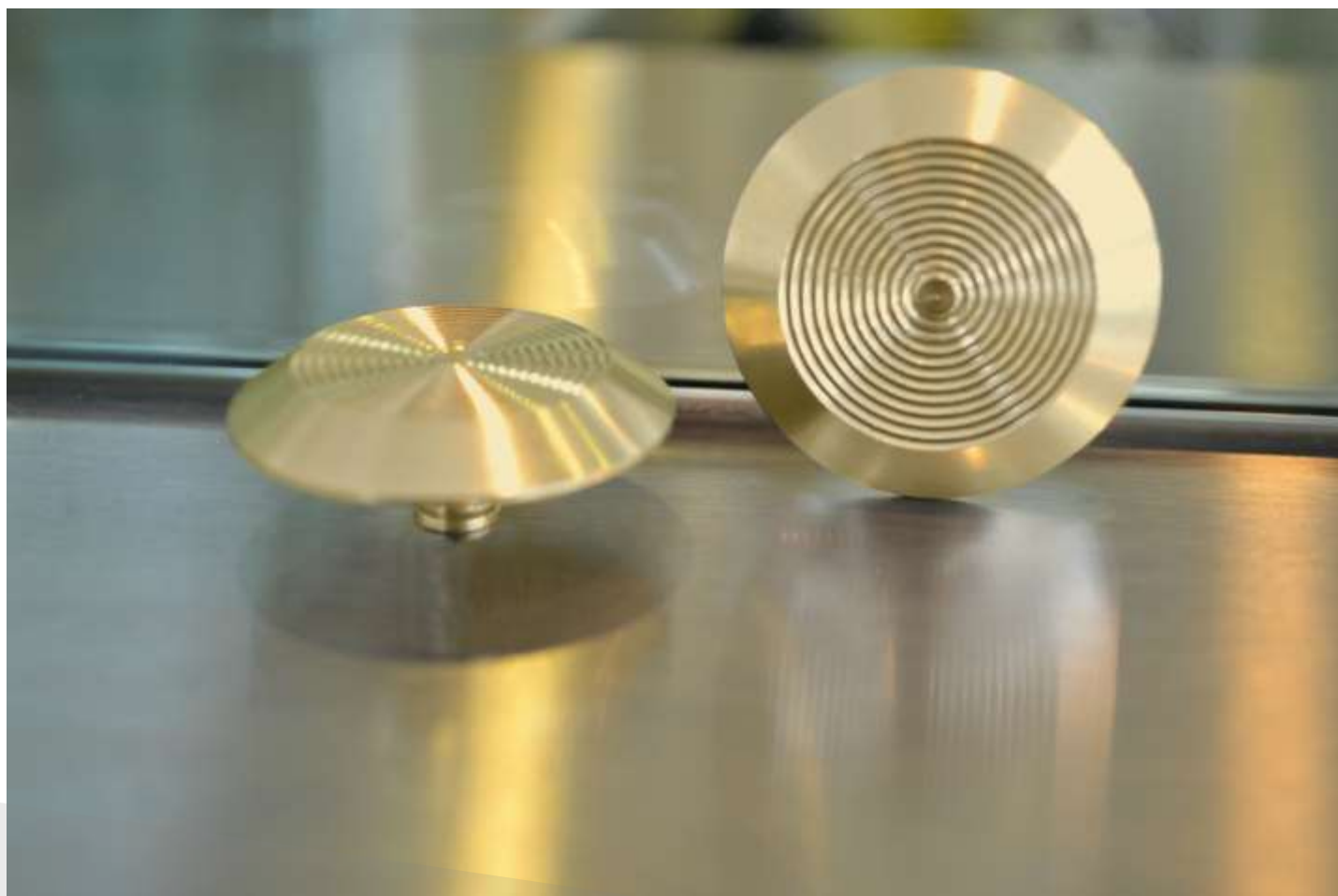

KENT BRASS TACTILE WARNING STUD (KBTWS 35/5/FDMG)

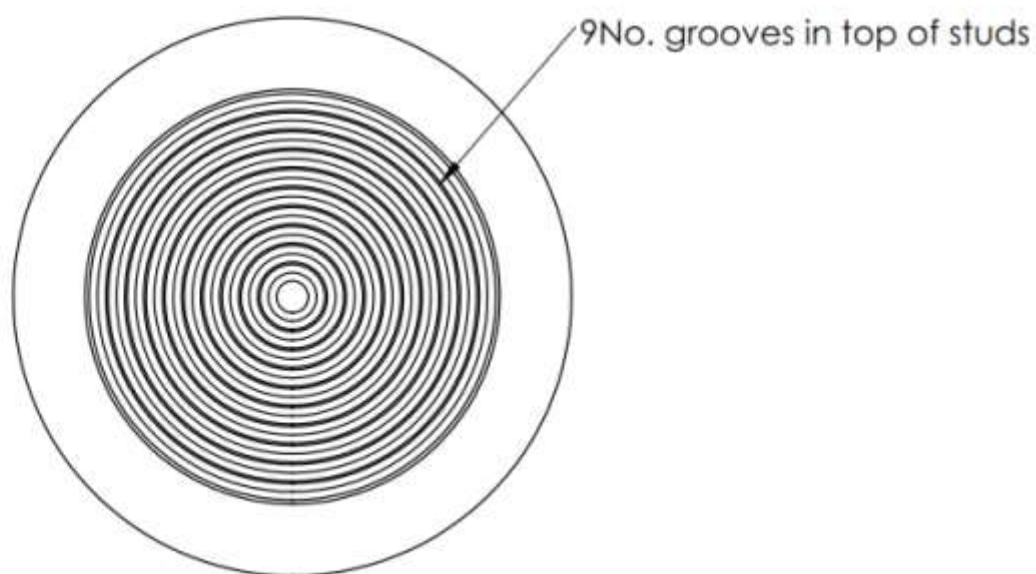
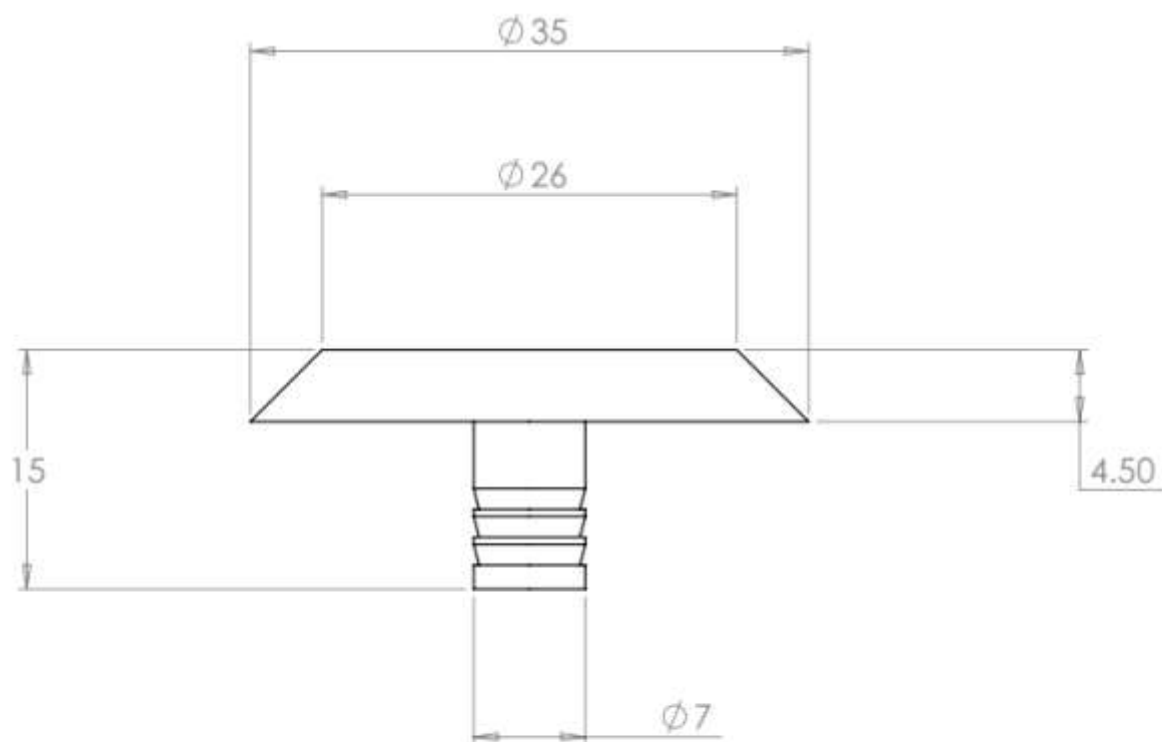

Product Code	Diameter	Height
Kent Brass Tactile Warning Stud KBTWS 35/5/FDMG	35mm	5mm

Installation of Studs

Step 1:

Drill x1 15mm Diameter hole 28mm deep.

Step 2:

Clean out the drilled hole.

Step 3:

Fill with chemical mortar (Kent Stainless recommend MIT-SE Mortar).

Step 4:

Insert the Kent Brass Tactile Warning Stud and leave to set for 24 hours

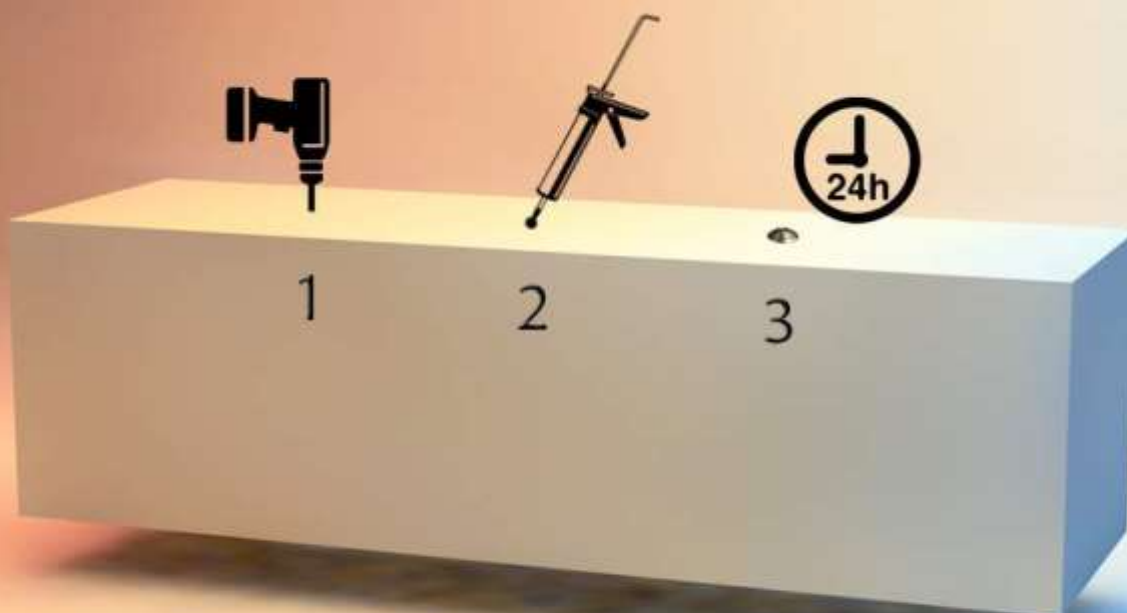

KENT BRASS TACTILE WARNING STUD (KBTWS 35/5/FDMG)

Specify

Specify:

Kent Brass Tactile Warning Stud (Multi Groove) KBTWS 35/5/FDMG; 35mm diameter x 5mm high; multi rings; Brass 59, 6mm dia x 14mm stud for root fixing below GL

*Choose your Size:
Standard 35mm dia
Bespoke sizes on request*



Kent Stainless Ltd
Ardcavan, Wexford, Ireland

TEL NO: +353 53 9143216
UK FREEPHONE: 0800 376 8377
FAX: +353 53 9141802
WEB: www.kentstainless.com
EMAIL: info@kentstainless.com

