



KVCR Deep Sump Floor Drain

The **KVCR265/4"RD Deep Sump Floor Drain** is a Round Top, Round Body/Bottom Outlet Drain for Heavy Duty Areas with High Flow Rates—typically 97 gallons per minute or 6 litres per second. This is a sealed cleanroom drain with a strong positive seal created by machining away a 0.4" (10mm) groove from a 0.6" (15mm) top plate. A 0.4" (10mm) top plate with a recessed 'o-ring' creates the seal. This top plate is then removable with a heavy duty suction cup available as an accessory. They are designed for use primarily in Pharmaceutical factories. They can be used in both light duty and very heavy duty trafficked areas (sealed gullies are most often used in laboratories or cleanrooms which are limited to pedestrian traffic - however the 0.4" (10mm) top plate makes it possible to drive heavy factory traffic over these gullies). As standard the KVCR265/4"RD takes a 0.4" (10mm) thick sealed grating but 0.4" (10mm) slotted and perforated gratings can also be used. In most cases a 4" or 6" SCH10 outlet is required because these are most popular with American Multinational Pharmaceutical companies who have scheduled stainless steel pipework to connect to, but this can easily be substituted for a 110mm or 160mm.

INDUSTRIES

- BioPharma
- Pharmaceutical
- Laboratories

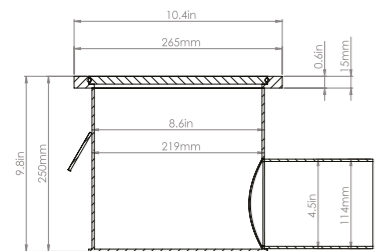
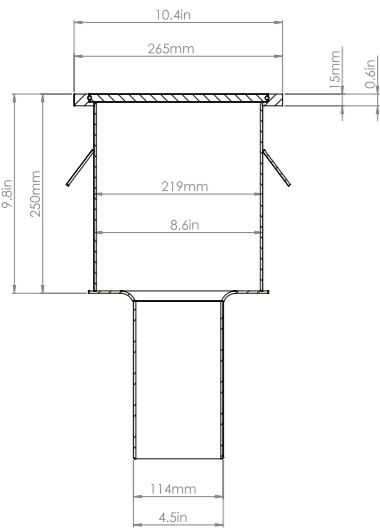

Product Code	Height	Top Diameter	Body Diameter	Outlet	Flow Rate US GPM
KVCR265/4" RD	9.84in (250mm)	10.43in (265mm)	8.6in (219mm)	4" Sch 10	97.8 GPM (6.17 l/s)
KVCR365/6" RD	9.84in (250mm)	14.37in (365mm)	12.55in (319mm)	6" Sch 10	228 GPM (14.39 l/s)
Side Outlet					
KHCR265/4" RD	9.84in (250mm)	10.43in (265mm)	8.6in (219mm)	4" Sch 10	82.42 GPM (5.2 l/s)
KHCR365/6" RD	9.84in (250mm)	14.37in (365mm)	12.55in (319mm)	6" Sch 10	127.9 GPM (8.07 l/s)



Sealed as standard - remove with suction cup

Slotted Cover - interchange with sealed when use of room changes in future

Secured LockDown Sealed Cover - when occasional back pressure can be expected

Top Connections Sealed Cover with Central Tundish

Top Connections Sealed Cover with 4 Staggered Ferrule Connections

Top Connections Slotted Covers with offset Tundish

Tops Round Top Standard for Poured Floors

Tops Square Top Options

Tops Vinyl Clamp Top Option

Fixed Height as standard

2 Part Adjustable Height version available

Bottom Outlet Push Fit (standard)

Bottom Outlet Threaded (optional)

Bottom Outlet With P Bend Trap

Side Outlet With Running Trap for side outlets

KVCR Bottom Outlet

KHCR Side Outlet